



## OPTIONS

### Methods of installation

- attached by bolts to foundation

### Logo

- none
- etching in stainless steel
- cut in steel
- sticker

## DESCRIPTION

The self-service bicycle repair station **Stilo**, is designed for ad-hoc repairs and adjustments of bicycles by the user himself, using the construction of the device as a base and tools included in the equipment of the repair station. The station can be used in the city for cycle paths as well as for long-distance trips. Due to its size, the station can be used by both children and adults.

The station is made of steel. The customer may choose a model made entirely of **stainless steel** or galvanised carbon steel powder-coated in a specified RAL colour. In the painted version, components such as the top bicycle rack and the inner wall with tool storage remain in stainless steel. The station is mounted to the ground with wall plugs. The bicycle repair tools are attached to the station with PVC-coated steel cables to prevent theft.

Tools: **screwdriver**; stainless steel Phillips and flathead **spanners**; stainless steel; 13, 14, 15, 16 mm **Allen spanners**; stainless steel; 2, 3, 4, 5, 6, 8 mm **hand pump**; compatible with Presta and Schreder valves **chain stripper**; 9, 10, 11 speed (supports Shimano 11 speed SPD, does not support Campagnolo 11 speed chain!); stainless steel **spoke (nipple) spanner**; Mavic MTB, 3.22, 3.45 and CNSPOKE spanner (3.2-3.3-3.4...

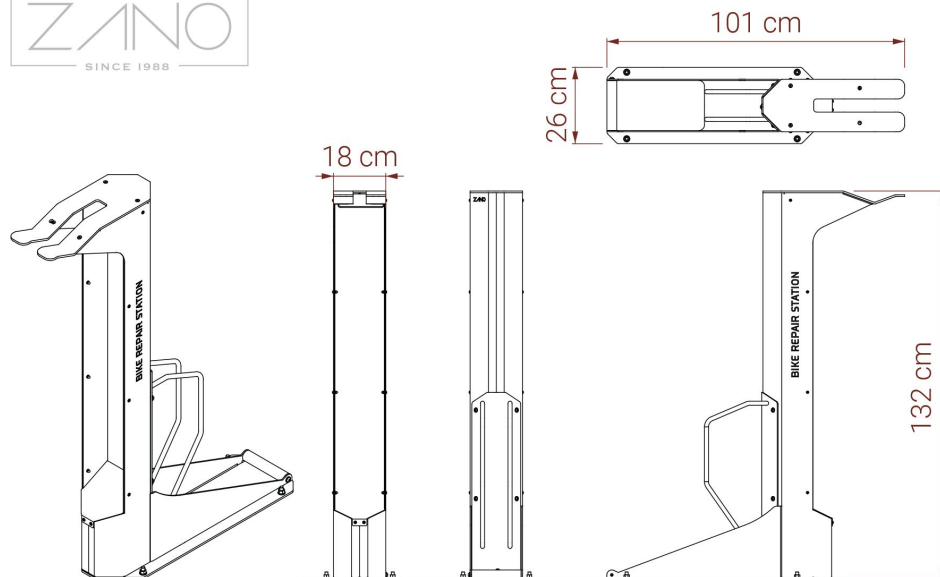

## GENERAL TECHNICAL DATA

### Materials

- stainless steel or carbon steel, galvanised and powder-coated in RAL colour

### Dimensions

- width: 26 cm  
- height: 132 cm  
- depth: 101 cm

### Weight

- 30 kg

ZANO



*Iwona Żaczek*

Product:  
Repair station for Stilo bicycles  
Catalog number: **18.048.1**  
Designer: Iwona Żaczek

In accordance with the Polish Law on Copyright and Related Rights of 04.02.1994 (Official Journal of Laws No. 24, item 83, corrected: Journal of Laws No. 43, item 170) and in accordance with the EU copyright legislation including all EU directives and regulations on copyright, Zano Mirosław Zarotynski Company, reserves the copyright of drawings, descriptions, 3D models, renderings, graphics, content contained in offers, attachments to offers and all other documents. Its content is the intellectual property of ZANO Mirosław Zarotynski company. The use of author's ideas, solutions, copying, distribution of photos, graphics or fragments of graphics, descriptive texts, for profit, without the permission of the author - ZANO Mirosław Zarotynski company - is prohibited and constitutes a copyright infringement and is punishable.

td>

**NOTE: The drawings do not reflect the actual dimensions of the foundation. They are only exemplary assembly schemes taking into account the type of anchoring and the substrate material to which the furniture is to be fixed.**

The size of the foundation depends on the local foundation conditions.



### INSTALLATION INTO PAVING WITH FOUNDATION

#### Description of the assembly

1. ZANO product
2. Quick-action fastener or chemical anchor
3. Stone paving / concrete paving / stone slabs / concrete slabs
4. Sand ballast (approx. 2 - 4 cm)
5. Stone aggregate substructure
6. Concrete foundation, class C16/20 (top surface concrete 10 cm below paving surface)
7. Ground



### INSTALLATION TO PAVING

#### Description of the assembly

1. ZANO product
2. Quick-action fastener or chemical anchor
3. Stone paving / concrete paving / stone slabs / concrete slabs
4. Sand ballast (approx. 2 - 4 cm)
5. Stone aggregate substructure
6. Ground



### CONCRETE / ASPHALT MOUNTING

#### Description of the assembly

1. ZANO product
2. Quick-action fastener or chemical anchor
3. Fixed hardened surface e.g. concrete or asphalt
4. Concrete foundation, class C16/20 (top surface concrete 10 cm below paving surface)
5. Stone aggregate substructure
6. Sand ballast (approx. 2 - 4 cm)
7. Ground

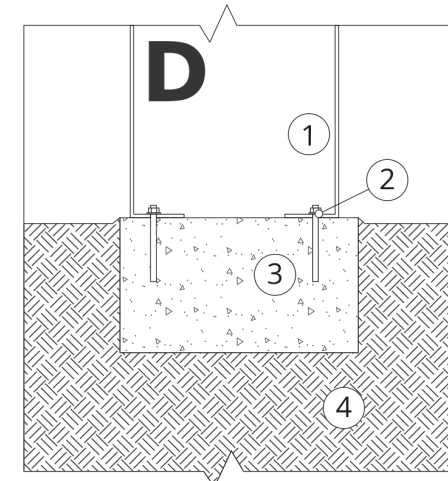

### MOUNTING TO CONCRETE FOUNDATION

#### Description of the assembly

1. ZANO product
2. Quick-action fastener or chemical anchor
3. Concrete foundation, class C16/20 (top surface concrete 10 cm below paving surface)
4. Ground